

MUTOH

Creation, we make it happen ...

RJ - 900

RJ-900 42" Full Color CAD printers

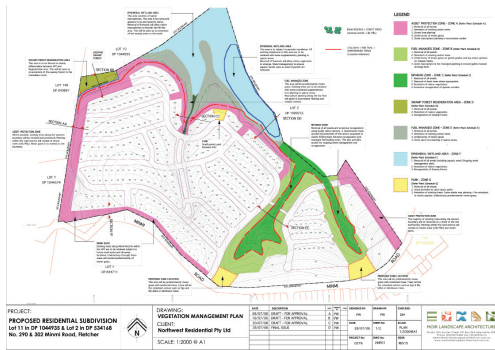

< High Output Speed - Up to 426 sq/ft/hr

< Industry's highest resolution for CAD: 1440 x 2880 dpi

< Latest generation piezo variable drop inkjet head (CMYK)

< Media and ink monitoring via network

< Small Footprint

< Windows® system driver - available in local languages

< Dedicated AutoCAD® HDI driver

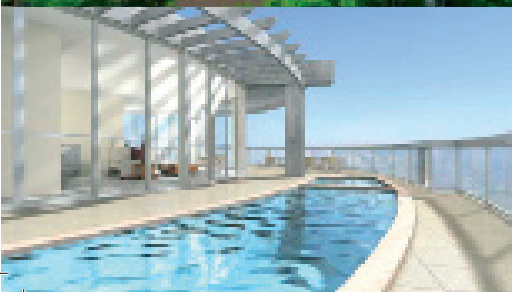

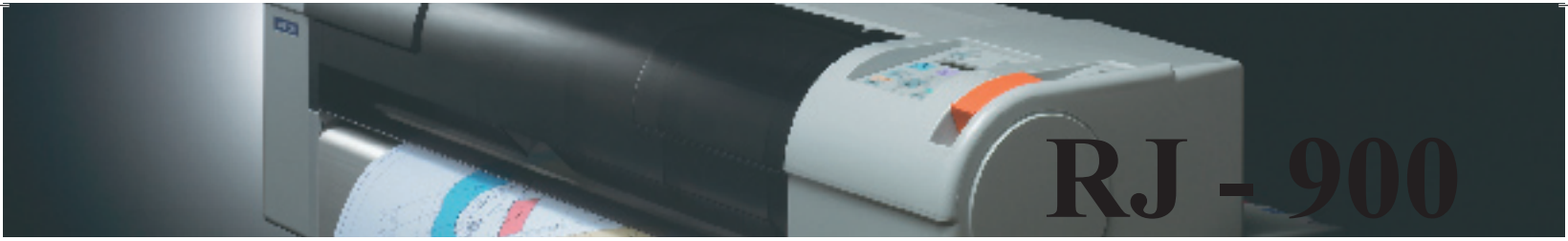

Mutoh's RJ-900, offering a maximum media size of 42", is a professional printer at an exceptional price point, specifically designed for architectural, engineering, construction, mechanical design and GIS applications.

The RJ-900 incorporates a new generation "Wide Model" print head (4 color sections, 360 nozzles/color), which will enable the highest resolution for CAD, 2880 dpi. The RJ-900 delivers superior line sharpness and photo quality with continuous tones, smooth transitions and a wide color gamut. Offering various print resolutions for different applications, the RJ-900 delivers a high speed 360 dpi printing 426 sq/ft/hr. The CMYK printer can be utilized with a variety of Ink sets.

Compactly designed, the RJ-900 will moreover deliver an easy installation and operation friendliness.

Printer Specifications :

Media Width	42.5 in.
Print Width	42.2 in.
Paper Gap Low/High	1.3 mm / 2.1 mm
Ink Type KCMY	Pigmented / Dye
Ink Capacity	Cassettes 110 ml /220 ml
Distance Accuracy	± 0.1%
Interfaces	USB 2.0 & Ethernet 10/100
Memory	256 Mb
Emulations	HP-GL,HP-GL2 & RTL-Pass
Noise Level	< 53 dB

Speed Specifications :

	Print mode (WavePrint OFF)	Speed in sq/ft/hr
High Speed 360, for CAD and Line Art	360 x 360 dpi – 1 pass Bi-Dir	426 sq/ft/hr
Standard 720, for High-End CAD	720 x 720 dpi – 4 pass Bi-Dir	84 sq/ft/hr
Imaging & Full Color	1440 x 1440 dpi – 4 pass Bi-Dir	42 sq/ft/hr

- The table only lists a selection of output resolutions and print quality modes. Available resolutions: 360x360, 720x360, 360x720, 720x720, 1440x720, 720x1440, 1440x1440, 2880x1440 and 1440x2880. Each resolution allows 6 quality/speed levels.

- Enabling the WavePrinting effect will reduce the output speed 4, 15 or 50%, depending on the selected wave effect.

Printer Dimensions:

Dimensions (WxDxH)	69 x 26 x 48 inches
Printer + stand Weight	250 lbs

Environmental Conditions:

Temperature : 59° F – 82.4° F / Relative Humidity (non-condensing) : 40 % RH – 65 % RH

All specifications and machine configurations subject to change without notice. All trademarks mentioned are property of their respective owners.

MUTOH

MUTOH AMERICA INC.
 Tel.: 480.968.7772
 Fax: 480.968.7990
 E-mail: sales@mutoh.com
 www.mutoh.com

Distributed by: